

**88 x 400 TRANSPARENT BI-FACIAL
11 x 8 PANELS 35.20KW LANDSCAPE**
ANNUAL ESTIMATED KWH YIELD = 105,600
GMI DUAL-AXIS STAR TRACKER WITH FAILSAFE(*)
NORMAL POSITION
MADE IN CONNECTICUT, USA

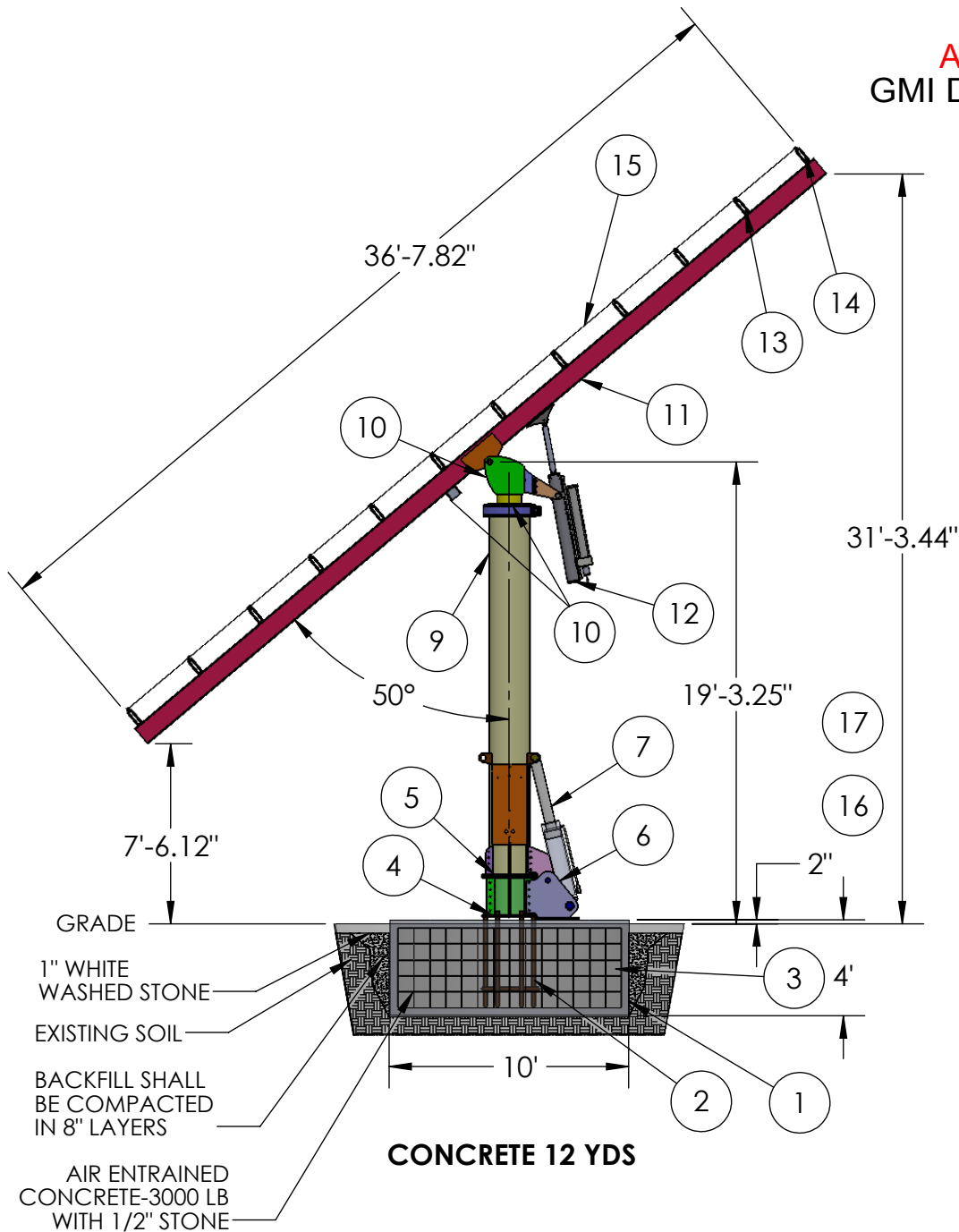

1. REBAR #4 CAGE 12" SPACING (INSTALL TO ASTM STANDARD)
2. ANCHOR RODS Ø1.50" FULL LENGTH
3. CONCRETE BASE 3000 LB WITH 1/2" STONE
4. BASE PLATE t=1"
5. COLUMN BASE 20" X .5" X-HEAVY
6. TILTING BASE SUPPORT ASSEMBLY
7. HYDRAULIC CYLINDER BORE 8" (USA) (WILL BE REMOVED AFTER INSTALLATION)
8. STEEL COLUMN X-HEAVY-DIA 20" X 15'
9. SLEW DRIVE & SLEW STOP
10. POLAR CAP
11. STRONGBACK
12. HYDRAULIC ACTUATOR 48" X 5" BORE (USA)
13. STEEL CANTILEVER
14. ALUMINUM SPAR
15. TRANSPARENT BI-FACIAL SOLAR PANELS
16. CONTROL PANEL
17. INVERTER PARKER CENTRAL INVERTER (CI)

PATENT PENDING

(*) FAILSAFE - INCLUDES BATTERY BACKUP WITH WIND SENSOR TO MOVE ARRAY AUTOMATICALLY TO FLAT (STOWED) POSITION

NOTE: WIND DESIGN SPEED = 100 MPH

PROPRIETARY AND CONFIDENTIAL

THE INFORMATION CONTAINED IN THIS DRAWING IS THE SOLE PROPERTY OF GM INDUSTRIES. ANY REPRODUCTION IN PART OR AS A WHOLE WITHOUT THE WRITTEN PERMISSION OF GM INDUSTRIES IS PROHIBITED.

GM INDUSTRIES, INC.

TITLE: GM STAR TRACKER

SIZE DWG. NO. 2

A TRACKER FOOTING & STRUCTURE PROFILE

GM INDUSTRIES
 350 BABCOCK RD.
 TOLLAND, CT 06084
 (860)-306-4442

SCALE: 1:86

DATE: 12/19/16

SHEET 2 OF 3